

LIONS FORWARD CAMPAIGN CO-CHAIRS LEAD THE WAY WITH \$1 MILLION GIFTS



Campaign Co-Chairs, **Bill and Tracy Gipson**
Missouri Southern President, **Dr. Dean and Mary Van Galen**
Honorary Campaign Co-Chairs, **Dot and Bob Willcoxon**

OFF TO A GREAT START

At Missouri Southern, our vision is to be a leader in offering relevant academic programs which fulfill the educational needs of each student. In an effort to continuously advance this vision, the university has launched *Lions Forward: The Campaign for Missouri Southern*.

In order to make each campaign project a reality, private support is a critical part of the equation. Collaborations with alumni, faculty/staff, friends, corporate partners, and foundations are needed to ensure resources are in place to continue Missouri Southern's history of student success.

The *Lions Forward* campaign was kick-started by \$1 million gifts from Bill and Tracy Gipson as well as Dot and Bob Willcoxon. Within the first six months of the campaign (July 1- December 31, 2022), 934 donors have made gifts in support of MSSU. These include 36 gifts of \$25,000 or more and 13 estate gifts.

With your help, *Lions Forward* will prove to be transformative for our students and our campus. With a gift to the campaign, YOU can make an impact on the lives of future Lions and on the communities we serve for generations.

OUR CAMPAIGN GOAL: \$31.5 MILLION IN PROJECTS

ENHANCING THE STUDENT EXPERIENCE

STUDENT SCHOLARSHIPS

Financially supporting students to help them focus on their studies and on-time graduation.

STUDENT SUCCESS CENTER

Creating a new one-stop shop for areas such as academic advising, career services, and tutoring.

BILLINGSLY STUDENT CENTER RENOVATION

Renovating the lower level of Billingsly into a new gathering space for students to increase engagement.

ATHLETIC EXCELLENCE FUND

An investment in facilities, student-athlete support services, and programs.

FOSTERING ACADEMIC EXCELLENCE

ACADEMIC EXCELLENCE

Investing in academic programs including those with high prospective student and workforce demand.

IMMERSIVE LEARNING OPPORTUNITIES

Expanding state-of-the-art facilities and immersive experiences such as study abroad and internships.

BUILDING THE CAMPUS OF THE FUTURE

HEALTH SCIENCE INNOVATION CENTER

A best-in-class education and training facility that will strengthen the university's position as a leader in the health sciences and advance collaborative relationships with regional partners.

HEALTH SCIENCE INNOVATION CENTER

Missouri Southern is the region’s leader in health science education, offering degrees in nursing, dental hygiene, radiological technology, respiratory therapy, emergency medicine/paramedic, and healthcare administration.

As part of the *Lions Forward* campaign, Missouri Southern is now seeking to construct a best-in-class education and training facility to help strengthen its leadership position and advance collaborative relationships with regional partners. The Health Science Innovation Center (HSIC) will facilitate the growth and development of vital health science programs.

The Health Science Innovation Center will contain:

- A simulation hospital (fully equipped facility to simulate a real-world hospital environment)
- Radiological technology laboratory (CT scan suite, ultrasound suite, and X-ray room)
- An expanded cadaver lab to meet the demand for hands-on anatomy training
- Collaborative research laboratories in partnership with Kansas City University – Joplin.

The Health Science Innovation Center will also contain a new welcome and conference center - to be the “front door” for the university’s prospective students and community.

Construction of this state-of-the-art facility will support Missouri Southern’s effort to double the number of nursing graduates and expand the number of other health science graduates each year. The simulation hospital will create an immersive learning opportunity for all health science students, accurately emulating the real-world experience they will encounter in their careers. Experiencing these situations in a simulated environment will make them far more effective in the early years of their healthcare careers.



Quality client care hinges on having a highly educated nursing workforce.

- Dr. Lisa M Beals DNP, MSN, RN, Nursing Department

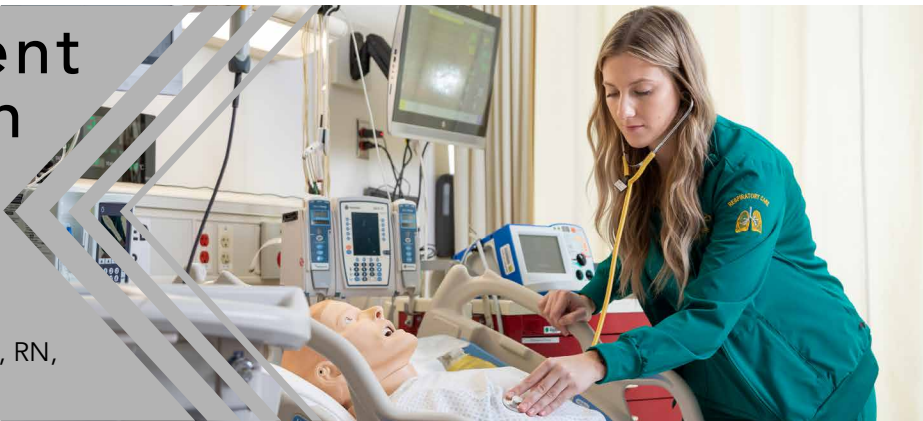

NEXT STEPS



Architect Selection

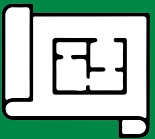

Project/Design Development



Construction



STUDENT CHOOSES MSSU FOR UNIQUE HANDS-ON LEARNING



Dhvani Patel, pre-med student from Texas, was accepted to several other prestigious schools but chose to pursue her education at MSSU. “As a pre-med student, I have always been interested in anatomy, but seeing the cadavers was a surreal experience, and I knew I needed more,” Patel explains.

“I am so thankful to MSSU for providing me opportunities to expand my knowledge and apply it to practical situations.” Patel expects to graduate from MSSU in the Spring of 2025 and will continue her education at KCU. She is a recipient of a privately-funded Foundation scholarship.

MCCUNE-BROOKS FOUNDATION SUPPORT



Miriam Putnam, Mariann Morgan, Pam Barlet, Patrick Scott, Tom Flanigan, Lora Honey-Phelps & Mark Elliff. **Not Pictured:** Dr. Jonathan Haffner

The McCune-Brooks Healthcare Foundation (MBHF) has a rich history of assisting MSSU in educating and training the next generation of healthcare professionals. Past gifts have funded scholarships, the Reynolds Hall renovation, and the McCune-Brooks Healthcare Foundation Department of Nursing.

Thanks to a recent commitment, the MBHF will play a big role in transforming campus and the student experience for generations of Lions to come. “We are proud to once again support the university with a commitment to the Health Science Innovation Center,” said Elizabeth Simmons, Executive Director.

THANK YOU TO OUR LEADERSHIP DONORS*:

- | | |
|-------------------------------|---------------------------------------|
| • Russ & Suzy Alcorn | • Delores & Jim Honey |
| • Sallie Beard | • Brian & Amy Ipsen |
| • Richard & Christine Beydler | • Steve Mackie |
| • Beverly & Ken Block | • Kyle Mayden |
| • Deron Burr | • McCune-Brooks Healthcare Foundation |
| • Mike & Leigh Carter | • Vicky & Steve Mieseler |
| • Steve & Sharon Chandler | • Anita & Brad Oplotnik |
| • Steve & Patty Chenault | • People’s Bank of Seneca |
| • Perry & Kim Davis | • R E Smith Construction |
| • Steven & Debbie Dodson | • Henry Robertson |
| • Jeff England | • Benji & Patty Rosenberg |
| • Russ & Wendy Fugate | • Dean & Mary Van Galen |
| • Bill & Tracy Gipson | • Bryan & Leticia Vowels |
| • Jim & Sue Goodknight | • Vowels Stovern Wealth |
| | • Terry Wachter |
| | • Dot & Bob Willcoxon |

PLANNED GIVING DONORS*:

- | | |
|---------------------------|--------------------------|
| • Russ & Suzy Alcorn | • Laurie & Gene Delano |
| • Vincent & Karen Beckett | • Jim & Brenda Jackson |
| • Beverly & Ken Block | • Teresa Massa |
| • Gay Burns | • Cynthia Schwab |
| • Deron Burr | • Myra Straub |
| • Jack & Teri Crusa | • Bryan & Leticia Vowels |

*From July 1st-December 31st, 2022

WANT TO DISCUSS HOW YOU CAN BE A PART OF THE CAMPAIGN? CALL (417) 625-3104.